

HOCHIKI ADDRESSABLE 'RESET' CALL POINT INSTALLATION INSTRUCTIONS



Products covered: SCP-DPS

IMPORTANT: These call points are suitable for use only with the particular class of system for which they are intended. These units are only compatible with the Enhanced Systems Protocol (ESP) and are for indoor use only. **Important Note – The use of lubricants, cleaning solvents or petroleum based products should be avoided.**

SETTING THE ESP LOOP ADDRESS

Ensure that each device has a unique address set before operation. Note the address can be set before or after connection to the loop, but the loop **MUST NOT** be powered. The address is set by utilising the 8-bit DIL switches on the reverse of the unit. Refer to the DIL Switch Address Table on page 2 (fig 4).

POLLING MODE

To switch the unit into Non-Polling mode, locate the DIL switches on the reverse of the unit and ensure DIL Switch number 8 is in the "OFF" (0) position. To switch on the unit's polling feature, ensure DIL Switch 8 is in the "ON" (1) position. Note that factory default is polling on.

MOUNTING / CONNECTION

Surface Mounting: The unit can be fitted to an optional back box (SCP-BACKBOX - not supplied). Fix the back box first using the provided screws (do not over tighten) ensuring the loop cables are passed into the back box through cut-out provided. Then fix the Wall Plate with the provided screws (see fig 1).

Use the unit's flying leads to connect to the loop cables, refer to fig 5 for correct wiring.

Flush Mounting: The Call Point will fit onto any standard UK single switch/socket box having 60mm horizontal fixing centres and a recommended minimum depth of 25mm (see fig 2).

Finally the cover should be attached to the Wall Plate. Place the top edge of the cover against the Wall Plate and then carefully hinge down onto the Wall Plate until it snaps into place (see fig 3).

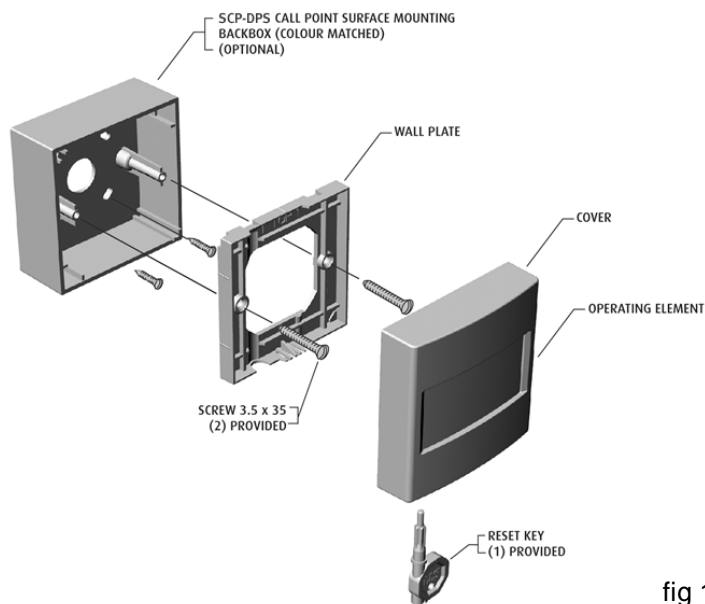

fig 1

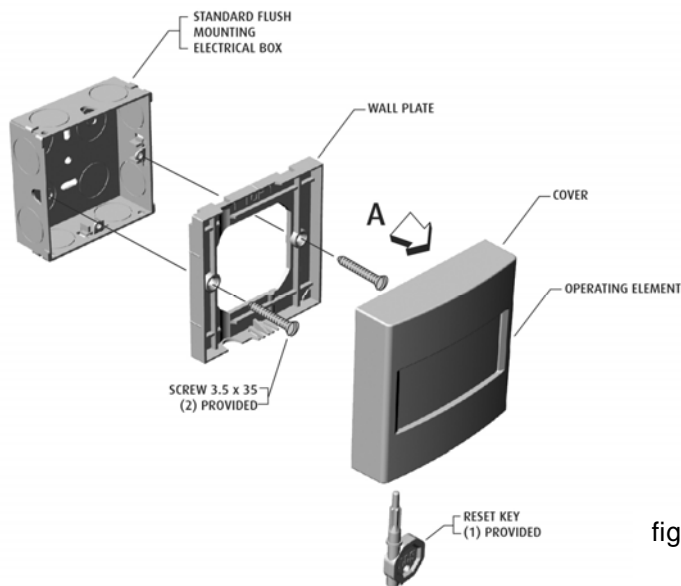

fig 2

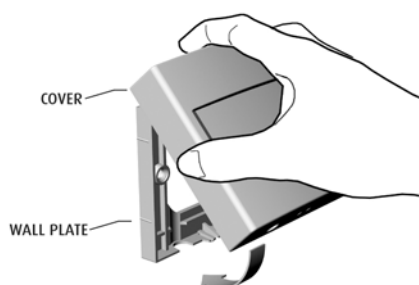

fig 3

TESTING

To test the call point press the plastic window at the point indicated until the black activation button clicks and the black and yellow activation pattern is displayed (in the top left corner behind the window).

RESETTING AFTER TESTING/ACTIVATION

To reset the call point insert the supplied test key into the aperture at the bottom of the unit – the black and yellow activation pattern will be pushed upwards, out of sight.

Then turn the test key one-quarter turn anti-clockwise until both the black activation button and plastic window pop outwards. The unit is now primed and ready for the next activation.

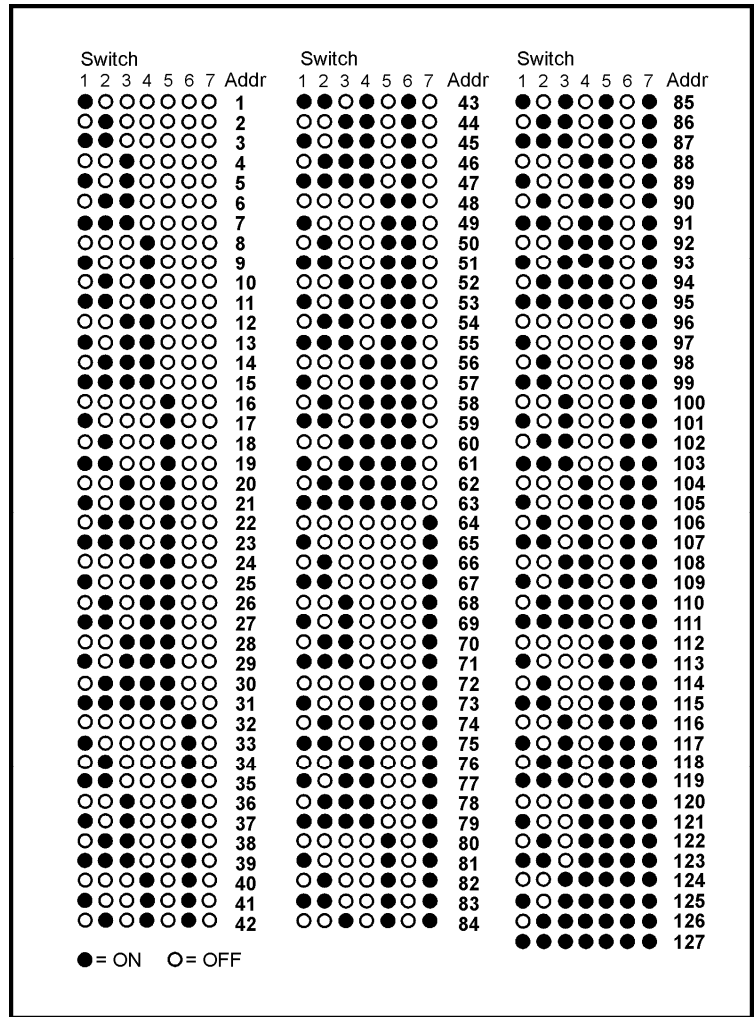

fig 4

SPECIFICATIONS	
Auxiliary Switch Rating	24Vd.c. @ 1A (non-inductive)
Housing Material	Polycarbonate
Electrical Contact Material	Silver plated brass
Operating Temp	-10°C to +50°C

AUXILIARY SWITCH CONTACTS

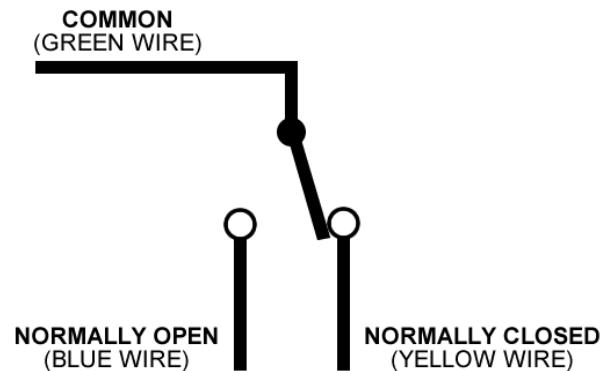

fig 5



Hochiki Europe (UK) Ltd
 Grosvenor Road, Gillingham Business Park,
 Gillingham, Kent, ME8 0SA, England
 Telephone: +44(0)1634 260133 Facsimile: +44(0)1634 260132
 Email: sales@hochikieurope.com
 Web: www.hochikieurope.com

Hochiki Europe (UK) Ltd. reserves the right to alter the specification of its products from time to time without notice. Although every effort has been made to ensure the accuracy of the information contained within this document it is not warranted or represented by Hochiki Europe (UK) Ltd. to be a complete and up-to-date description. Please check our web site for the latest version of this document.